

## E4DL

LED Commercial Downlight  
Selectable CCT & Wattage  
4", 6", 8", & 10" options • 10-yr Warranty



## OVERVIEW

Energetic Lighting's E4DL series is suitable for use in a broad range of commercial applications. Available in 4 profile sizes from 4", 6", 8", up to 10", covering almost any application project. Utilizing today's latest innovative LED solutions and technologies paired with world class manufacturing practices, the E4DL provides customers an affordable LED downlight offering with the perfect blend of design, performance, value and reliability. An extremely versatile product thanks to its stand-alone design without the need for a traditional recessed can housing. A flexible metal conduit pigtail with 1/2" trade-size adapter is included for power connection. With our integral EZCCT field-selectable CCT along with EZWATT field-selectable wattage (6", 8", 10" only), these downlight extend use to a broad range of commercial and industrial applications, at the same time reducing the need for stocking CCT and wattage variable units. The E4DL series is a great choice for renovation opportunities replacing existing commercial downlight fixtures or for new construction projects that require code compliant energy saving LED solutions. Ideally suited for office spaces, schools, retail, hospitality and healthcare applications, the E4DL provides high quality illumination with optimal energy savings.

## KEY FEATURES

- EZCCT field-selectable CCT for all models with - 3000K, 3500K & 4000K @ >90 CRI
- EZWATT field-selectable Wattage - 3 steps (6", 8", and 10" profiles), varied by models (see stock ordering information)
- 4", 6", 8", and 10" profiles available for design flexibility
- Suitable for Type-IC on models: 4", 6", & 8"; note: 10" profile model is Type Non-IC only
- External spring arms install to mounting surface without the need for a traditional recessed can
- Integrated flexible metal conduit pigtail lead with snap-in 1/2" trade-size knockout adapter, 24" total length provided for flexible installation options
- Strong and reliable spring loaded capture mounting arms ensure flush installation as well as safety (mechanical safety cable also provided as precautionary in case of mounting surface failure)
- Minimum 81% lumen maintenance @ 50,000 hours - L81/50,000 (per IES TM21)
- Suitable for wet location installations

## Highlights



Field-selectable CCT and wattage control provides flexibility to installation and stocking



Universal spring clip arms allows direct mounting to surface without need for recessed can housing

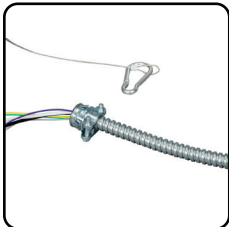

Flexible metal conduit lead with 1/2" trade-size knockout adapter; safety cable also provided



Stepped baffle trim for optical diffusion and modern aesthetic design

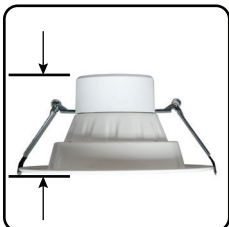

Without the need for a recessed can housing, the plenum height needs only accommodate the downlight body height

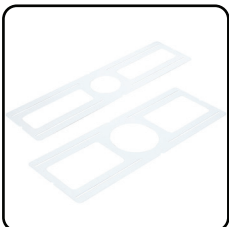

Optional Rough-in plates available in 4", 6", 8", or 9" downlight diameters (see next page for more details)

## Load Information

<b>Input Voltage</b>	120-347Vac	
<b>Power Factor</b>	0.98	
<b>THD</b>	11%	
<b>Low Temp Start</b>	-25°C (-13°F)	
<b>Max Temp</b>	45°C (113°F)	
<b>Unit Weight</b>	4" profile	1.0 LBS
	6" profile	1.4 LBS
	8" profile	2.0 LBS
	10" profile	2.2 LBS

## Dimensions

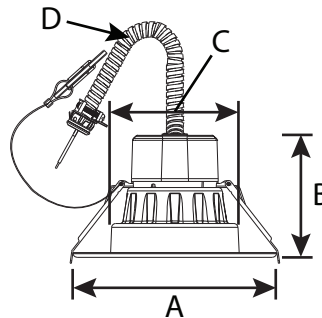

Description	Dim	Model profile			
		4" profile	6" profile	8" profile	10" profile
Front diameter (thru-hole upper limit diameter)	A	5.8"	8.3"	10.2"	11.2"
Overall Height	B	3.7"	4.0"	4.3"	4.6"
Min thru-hole diameter	C	3.6"	5.8"	7.2"	8.2"
Conduit overall length	D	24"	24"	24"	24"

## Shipping Information

Item	Weight	Box Qty.
4" profile	7 lbs	6 per
6" profile	10 lbs	6 per
8" profile	13 lbs	6 per
10" profile	16 lbs	6 per

## Lumen Maintenance

Profile	TM-21 Lumen Maint. (50,000 hours)	Theoretical L70 (hours)
4"	>83%	94,000
6"	>89%	162,000
8"	>83%	93,000
10"	>81%	86,000

Ambient Temperature: 25°C

## Specific Lumen Output

Profile	Wattage Setting	Color Temperature Setting		
		3000K	3500K	4000K
4"	12W	920	998	955
	10W	800	832	800
	12W	1000	1040	1001
6"	14W	1200	1296	1243
	17W	1450	1566	1502
	20W	1750	1890	1813
8"	30W	2300	2446	2368
	35W	2700	2872	2751
	40W	3150	3351	3245

**STOCK ORDERING INFORMATION**

**4" Profile**

Catalog Logic	Order #	Lumens	Wattage	LPW	Color Temp	CRI	Voltage	Dimming	Energy Star	Pallet Qty
E4DLH12D4-93040	50037	920 LM	12	78.5	3000K, 3500K, 4000K selectable	93	120-347	0-10v	Energy Star	TBA

**6" Profile**

Catalog Logic	Order #	Lumens	Wattage	LPW	Color Temp	CRI	Voltage	Dimming	Energy Star	Pallet Qty
E4DLH1017D6-93040	50038	800, 1000, 1400 (LM) Selectable	10W, 12W, 17W selectable	85	3000K, 3500K, 4000K selectable	93	120-347	0-10v	Energy Star	300

**8" Profile**

Catalog Logic	Order #	Lumens	Wattage	LPW	Color Temp	CRI	Voltage	Dimming	Energy Star	Pallet Qty
E4DLH1420D8-93040	50039	1200, 1450, 1750 (LM) Selectable	14W, 17W, 20W selectable	88.5	3000K, 3500K, 4000K selectable	93	120-347	0-10v	Energy Star	180

**10" Profile**

Catalog Logic	Order #	Lumens	Wattage	LPW	Color Temp	CRI	Voltage	Dimming	Energy Star	Pallet Qty
E4DLH3040D10-93040	50040	2300, 2700, 3150 (LM) Selectable	30W, 35W, 40W selectable	79.5	3000K, 3500K, 4000K selectable	93	120-347	0-10v	Energy Star	180

**Optional Accessories**

**E1RIP-4**

Rough-in plate for 4" downlights

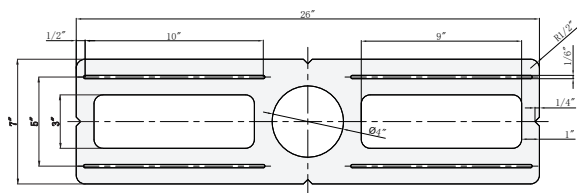

**E1RIP-8**

Rough-in plate for 8" downlights

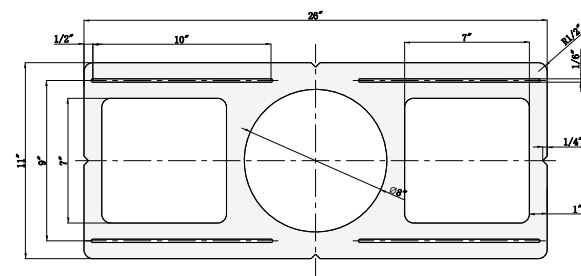

**E1RIP-6**

Rough-in plate for 6" downlights

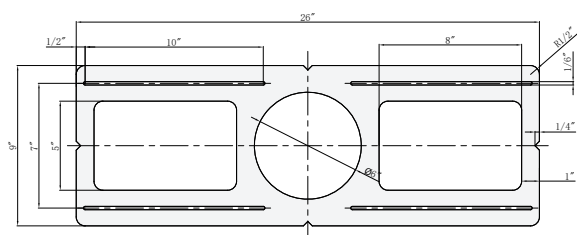

**E1RIP-10**

Rough-in plate for 10" downlights

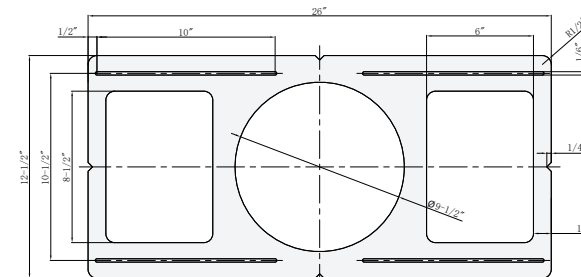

**PHOTOMETRIC DATA**

Cat Logic: E4DLH12D4-93040 \*  
 Test Report: E4DLH12D4-93040\_(3000K).IES  
 CCT: set at 3000K for test  
 Lamp Type: LED  
 Lumens: 920 LM  
 Input Watts: 11.98 W  
 Efficacy: 77 LM/W  
 Spacing Criteria: [0° : 1.18] [90° : 1.18]

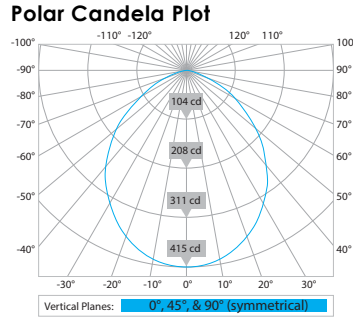

**Zonal Lumen Summary**

Zone	Lumens	%Luminaire
0-20	149.02	16.2
0-30	309.79	33.7
0-40	494.19	53.7
0-60	805.05	87.5
0-80	914.69	99.4
0-90	920.12	100
0-180	920.12	100

**Coefficients of Utilization**

Effective Floor Cavity Reflectance 0.20

rc	80%				70%				50%			30%			10%			0%
	rw	50	30	10	70	50	30	10	50	30	10	50	30	10	50	30	10	0
RCR																		
0	119	119	119	119	116	116	116	116	111	111	111	106	106	106	102	102	102	100
1	110	106	103	99	108	104	101	98	100	97	95	96	94	92	92	91	89	87
2	102	94	88	83	99	92	87	82	89	84	80	86	82	79	83	80	77	75
3	93	84	77	71	91	82	76	70	79	74	69	77	72	68	74	70	67	65
4	86	75	67	61	84	74	66	61	71	65	60	69	63	59	67	62	58	56
5	80	68	59	53	77	67	59	53	64	58	52	63	57	52	61	55	51	49
6	74	61	53	47	72	60	52	47	59	52	46	57	51	46	55	50	46	44
7	69	56	48	42	67	55	47	42	54	46	41	52	46	41	51	45	41	39
8	64	51	43	38	62	50	43	37	49	42	37	48	42	37	47	41	37	35
9	60	47	39	34	58	47	39	34	45	39	34	44	38	34	43	38	33	32
10	56	44	36	31	55	43	36	31	42	35	31	41	35	31	40	35	31	29

\* NOTE: Data produced from 3000K CCT setting where:  
 - 3500K values can be estimated by increasing of 1.085 factor from 3000K  
 - 4000K values can be estimated by increasing by a factor of 1.038 from 3000K

**Isofootcandle Sampling**

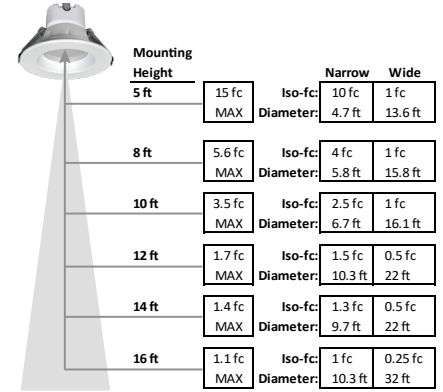

**PHOTOMETRIC DATA**

Cat Logic: E4DLH1017D6-93040 \*  
 Test Report: E4DLH1017D6-93040\_(3000K).IES  
 CCT: set at 3000K & 17W for test  
 Lamp Type: LED  
 Lumens: 1400 LM  
 Input Watts: 16.25 W  
 Efficacy: 90 LM/W  
 Spacing Criteria: [0° : 1.24] [90° : 1.24]

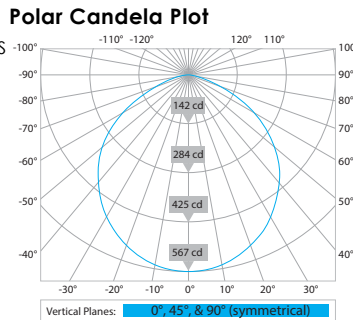

**Zonal Lumen Summary**

Zone	Lumens	%Luminaire
0-20	206.32	14.2
0-30	436.19	30
0-40	711.39	48.9
0-60	1239.96	85.2
0-80	1448.9	99.5
0-90	1456.15	100
0-180	1456.15	100

**Coefficients of Utilization**

Effective Floor Cavity Reflectance 0.20

rc	80%				70%				50%			30%			10%			0%
	rw	50	30	10	70	50	30	10	50	30	10	50	30	10	50	30	10	0
RCR																		
0	119	119	119	119	116	116	116	116	111	111	111	106	106	106	102	102	102	100
1	110	106	102	99	107	104	100	97	99	96	94	95	93	91	92	90	88	86
2	101	93	87	82	98	91	85	81	88	83	79	85	81	77	82	78	75	73
3	92	82	75	69	90	81	74	68	78	72	67	75	70	66	73	68	64	62
4	85	73	65	58	82	72	64	58	69	63	57	67	61	56	65	60	56	54
5	78	66	57	51	76	64	56	50	62	55	50	60	54	49	59	53	49	47
6	72	59	50	44	70	58	50	44	56	49	44	55	48	43	53	47	43	41
7	67	54	45	39	65	53	45	39	51	44	39	50	43	38	49	43	38	36
8	62	49	41	35	61	48	40	35	47	40	35	46	39	34	45	39	34	32
9	58	45	37	31	57	44	37	31	43	36	31	42	36	31	41	35	31	29
10	54	41	34	29	53	41	33	28	40	33	28	39	33	28	38	32	28	26

\* NOTE: Data produced from 3000K CCT setting where:  
 - 3500K values can be estimated by increasing of 1.040 factor from 3000K  
 - 4000K values can be estimated by increasing by a factor of 1.000 from 3000K  
 Data produced from highest wattage setting where lower wattage data values may be estimated by an equivalent proportional reduction as the wattage reduction factor (example: 17W to 12W use 0.706 reduction factor)

**Isofootcandle Sampling**

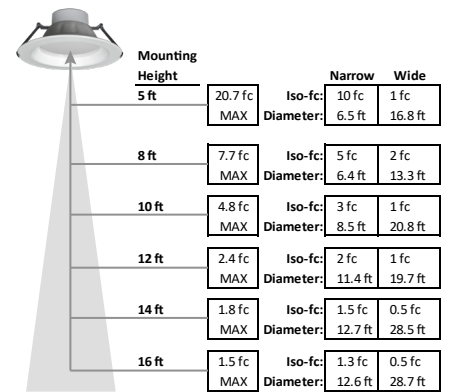

**PHOTOMETRIC DATA**

Cat Logic: E4DLH1420D8-93040 \*  
 Test Report: E4DLH1420D8-93040\_(3000K).IES  
 CCT: set at 3000K & 20W for test  
 Lamp Type: LED  
 Lumens: 1750 LM  
 Input Watts: 19.96 W  
 Efficacy: 88 LM/W  
 Spacing Criteria: [0° : 1.22] [90° : 1.22]

**Polar Candela Plot**

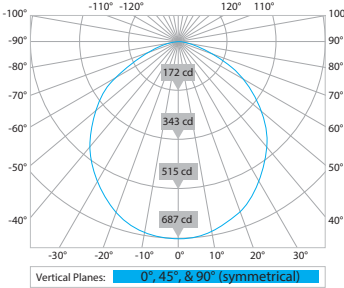

**Zonal Lumen Summary**

Zone	Lumens	%Luminaire
0-20	249.06	14.2
0-30	524.48	30
0-40	850.43	48.6
0-60	1469.65	84
0-80	1741.14	99.5
0-90	1750.21	100
0-180	1750.22	100

**Coefficients of Utilization**

Effective Floor Cavity Reflectance 0.20

rc	80%				70%				50%			30%			10%			0%	
	rw	50	30	10	70	50	30	10	50	30	10	50	30	10	50	30	10	0	
RCR																			
0	119	119	119	119	116	116	116	116	111	111	111	106	106	106	102	102	102	100	
1	110	106	102	98	107	103	100	97	99	96	94	95	93	91	92	90	88	86	
2	100	93	86	81	98	91	85	80	87	82	78	84	80	76	81	78	75	73	
3	92	82	74	68	89	80	73	67	77	71	66	75	69	65	72	68	64	62	
4	84	73	64	58	82	71	64	58	69	62	57	67	61	56	65	59	55	53	
5	78	65	57	50	76	64	56	50	62	55	49	60	54	49	58	53	48	46	
6	72	59	50	44	70	58	50	44	56	49	43	54	48	43	53	47	43	41	
7	67	53	45	39	65	53	44	39	51	44	38	50	43	38	48	42	38	36	
8	62	49	40	35	60	48	40	35	47	40	34	46	39	34	44	38	34	32	
9	58	45	37	31	57	44	36	31	43	36	31	42	36	31	41	35	31	29	
10	54	41	34	28	53	41	33	28	40	33	28	39	33	28	38	32	28	26	

\* NOTE: Data produced from 3000K CCT setting where:  
 -3500K values can be estimated by increasing of 1.080 factor from 3000K  
 -4000K values can be estimated by increasing by a factor of 1.036 from 3000K  
 Data produced from highest wattage setting where lower wattage data values may be estimated by an equivalent proportional reduction as the wattage reduction factor (example: 20W to 17W use 0.85 reduction factor)

**Isofootcandle Sampling**

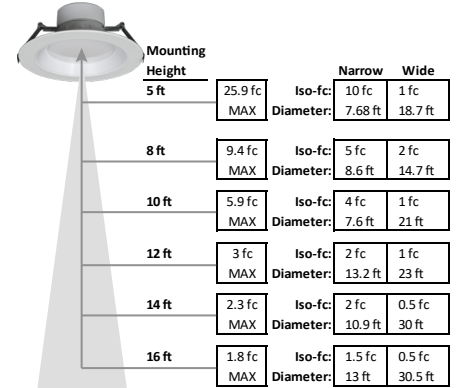

**PHOTOMETRIC DATA**

Cat Logic: E4DLH3040D10-93040 \*  
 Test Report: E4DLH3040D10-93040\_(3000K).IES  
 CCT: set at 3000K & 40W for test  
 Lamp Type: LED  
 Lumens: 3150 LM  
 Input Watts: 39.92 W  
 Efficacy: 79 LM/W  
 Spacing Criteria: [0° : 1.22] [90° : 1.22]

**Polar Candela Plot**

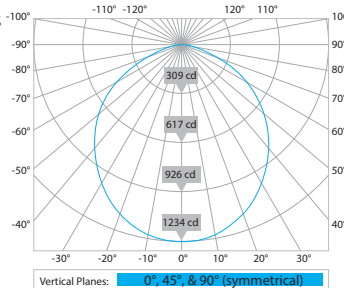

**Zonal Lumen Summary**

Zone	Lumens	%Luminaire
0-20	446.88	14.2
0-30	938.73	29.8
0-40	1517.7	48.2
0-60	2619.07	83.1
0-80	3132.63	99.4
0-90	3150.32	100
0-180	3150.37	100

**Coefficients of Utilization**

Effective Floor Cavity Reflectance 0.20

rc	80%				70%				50%			30%			10%			0%	
	rw	50	30	10	70	50	30	10	50	30	10	50	30	10	50	30	10	0	
RCR																			
0	119	119	119	119	116	116	116	116	111	111	111	106	106	106	102	102	102	100	
1	110	105	101	98	107	103	100	96	99	96	93	95	93	90	91	90	88	86	
2	100	92	86	81	98	91	85	80	87	82	78	84	80	76	81	77	74	72	
3	92	82	74	68	89	80	73	67	77	71	66	74	69	65	72	67	64	61	
4	84	72	64	58	82	71	63	57	69	62	56	66	60	56	64	59	55	53	
5	77	65	56	50	75	64	56	49	62	54	49	60	53	48	58	52	48	46	
6	72	59	50	44	70	58	49	43	56	48	43	54	48	43	53	47	42	40	
7	66	53	45	39	65	52	44	38	51	43	38	49	43	38	48	42	38	36	
8	62	49	40	34	60	48	40	34	47	39	34	45	39	34	44	38	34	32	
9	58	45	37	31	56	44	36	31	43	36	31	42	35	31	41	35	30	29	
10	54	41	33	28	53	41	33	28	40	33	28	39	32	28	38	32	28	26	

\* NOTE: Data produced from 3000K CCT setting where:  
 -3500K values can be estimated by increasing of 1.063 factor from 3000K  
 -4000K values can be estimated by increasing by a factor of 1.030 from 3000K  
 Data produced from highest wattage setting where lower wattage data values may be estimated by an equivalent proportional reduction as the wattage reduction factor (example: 40W to 35W use 0.875 reduction factor)

**Isofootcandle Sampling**

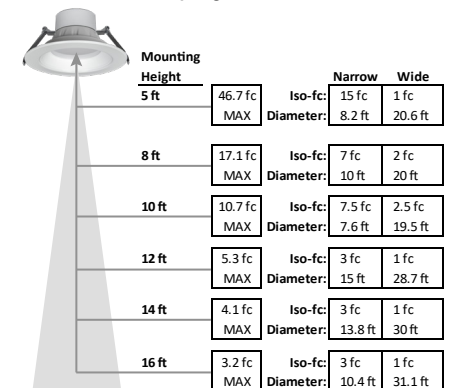



**ENERGETIC**  
L I G H T I N G

**E4DL**

CCT&W-Select LED Commercial Downlight  
50,000 System Lifetime • 10-yr Warranty

**NOTES:**

A large, empty rectangular box with a blue border, intended for user notes or specifications.



**ENERGETIC**  
L I G H T I N G

**E4DL**

CCT&W-Select LED Commercial Downlight  
50,000 System Lifetime • 10-yr Warranty

**NOTES:**

A large, empty rectangular box with a blue border, intended for user notes or specifications.